

REV:	DESCRIPTION	BY:	DATE:

**hitech**  **Hi-Tech iSolutions LLP**  
 Commerce House-4,  
 9th Floor, Prahaladnagar, Ahmedabad  
 Phone: +91-794-000-3000  
 www.hitechdigital.com

**TITLE: DOUBLE DOOR CABINET**

JOB#:	DRAWN:	REV:
10-001	Hi-Tech	
DATE:	SCALE:	PAGE:
12-29-2020	1/8	1 of 16

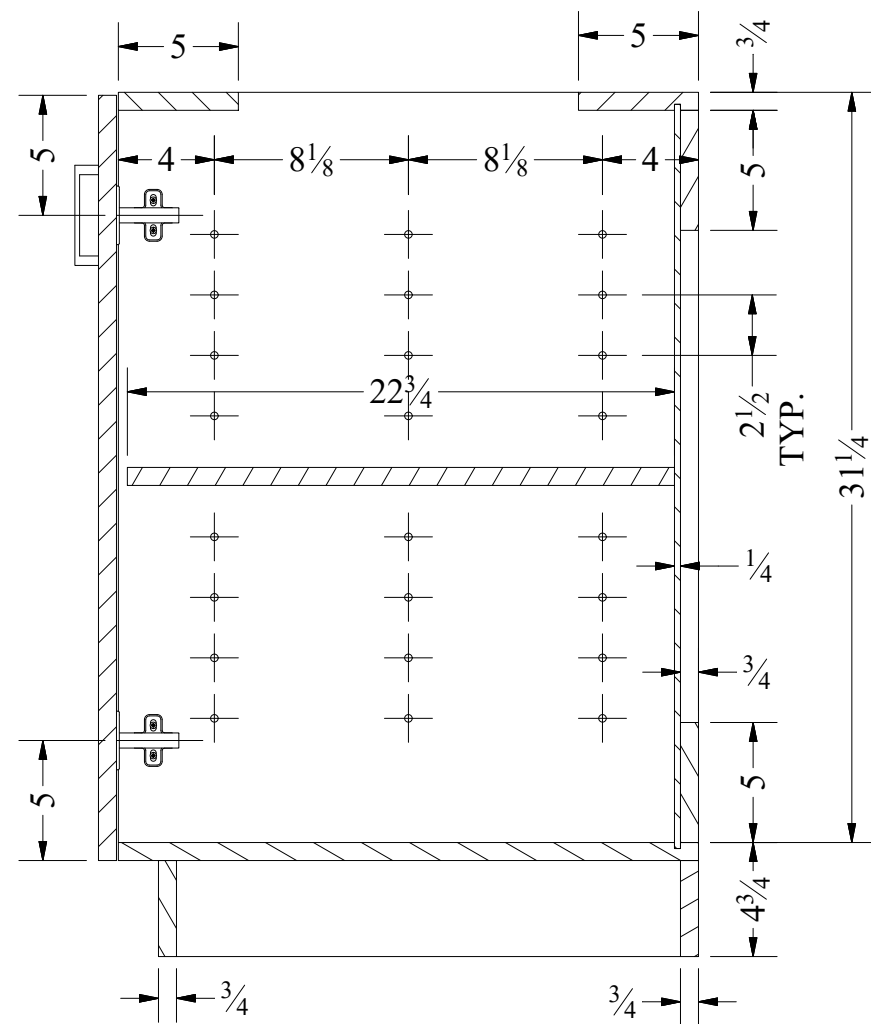

SECTION A-A

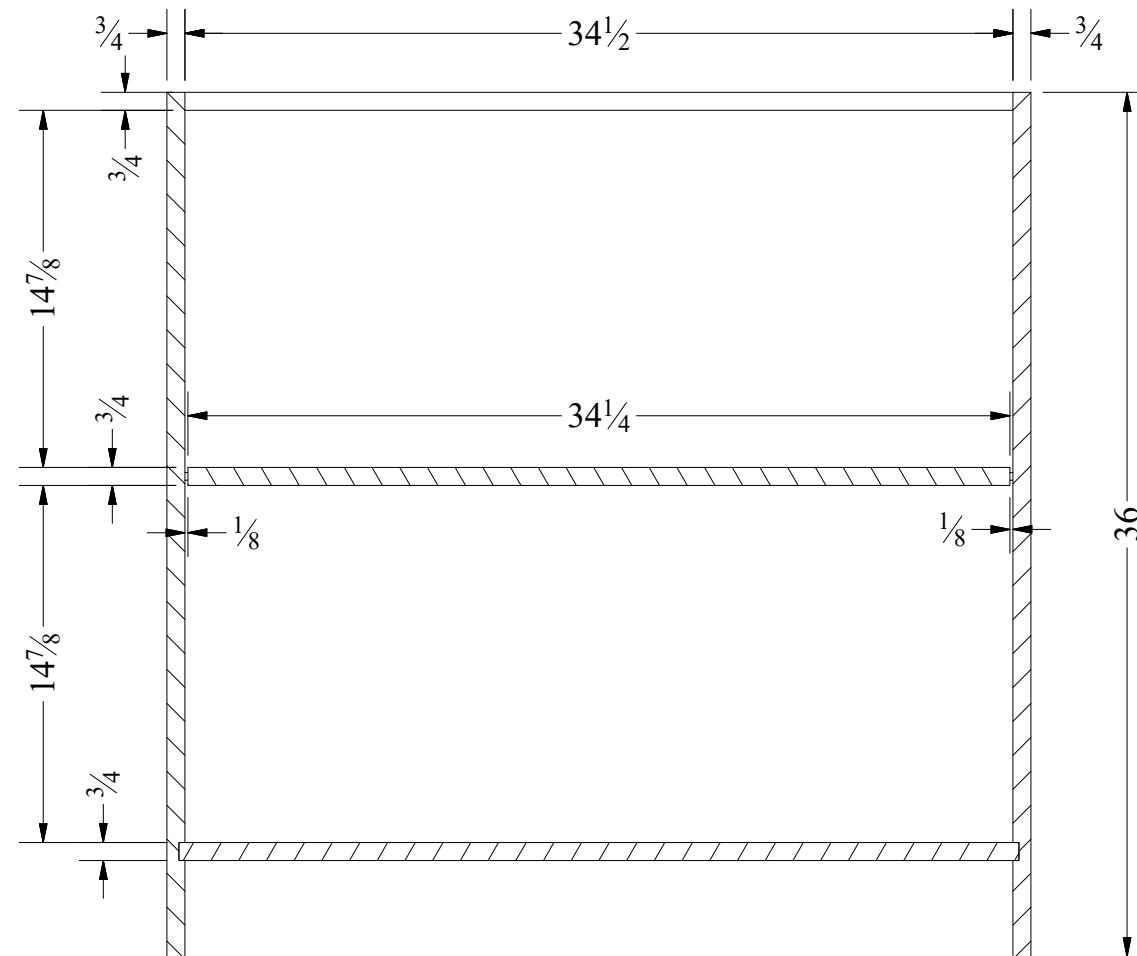

SECTION B-B

REV:	DESCRIPTION	BY:	DATE:

**Hi-Tech iSolutions LLP**  
 Commerce House-4,  
 9th Floor, Prahaladnagar, Ahmedabad  
 Phone:+91-794-000-3000  
 www.hitechdigital.com

**TITLE: DOUBLE DOOR CABINET**

<b>JOB#:</b> 10-001	<b>DRAWN:</b> Hi-Tech	<b>REV:</b>
<b>DATE:</b> 12-29-2020	<b>SCALE:</b> 1/8	<b>PAGE:</b> 2 of 16

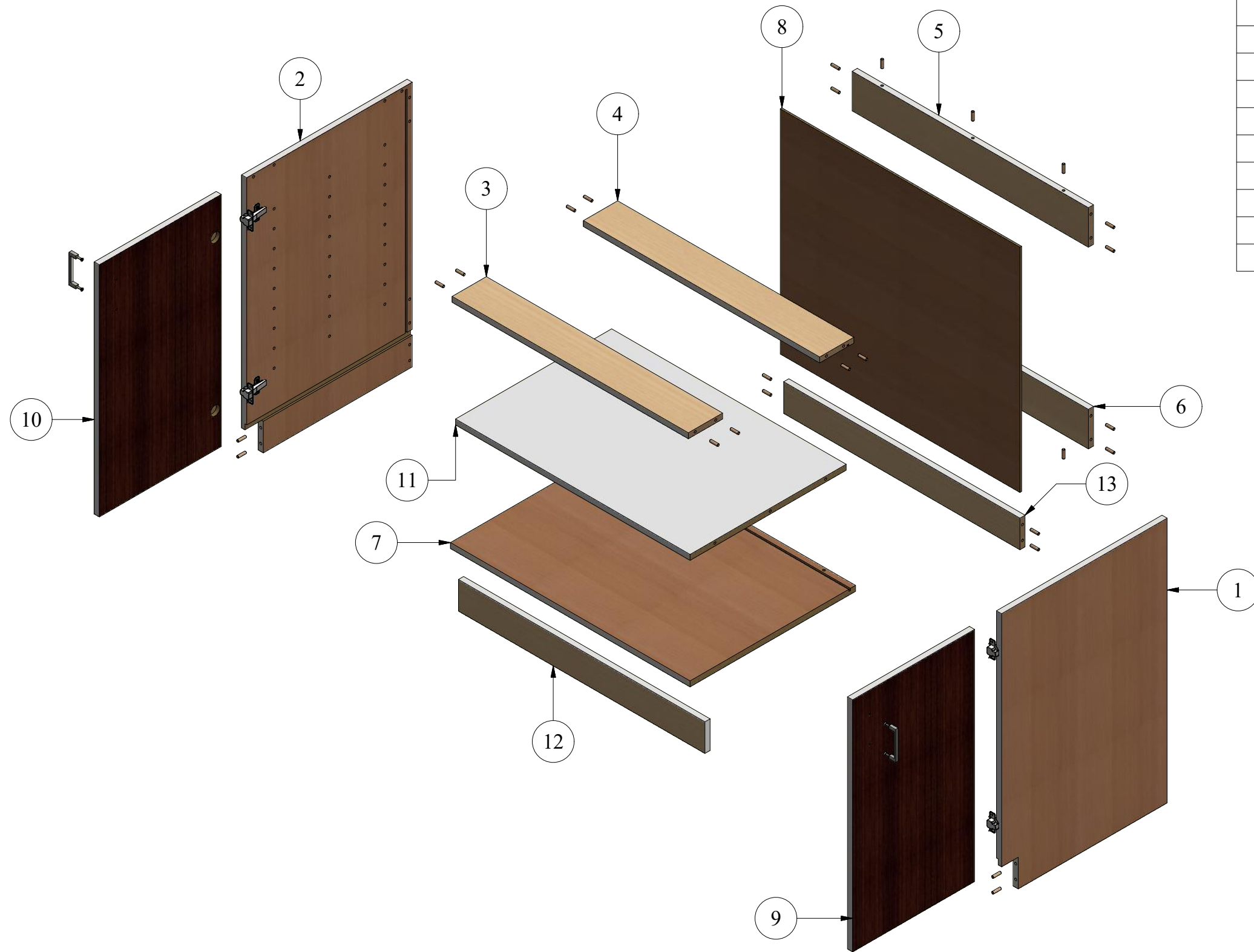

PARTS LIST			
ITEM	PART NUMBER	DESCRIPTION	QTY
1	001	RIGHT PANEL	1
2	002	LEFT PANEL	1
3	003	TOP NAILBOARD 1	1
4	004	TOP NAILBOARD 2	1
5	005	BACK NAILBOARD 1	1
6	006	BACK NAILBOARD 2	1
7	007	BOTTOM PANEL	1
8	008	BACK PANEL	1
9	009	RIGHT DOOR	1
10	010	LEFT DOOR	1
11	011	ADJUSTABLE SHELF	1
12	012	FRONT TOE KICK	1
13	013	REAR TOE KICK	1

REV:	DESCRIPTION	BY:	DATE:

**Hi-Tech iSolutions LLP**  
 Commerce House-4,  
 9th Floor, Prahaladnagar, Ahmedabad  
 Phone:+91-794-000-3000  
 www.hitechdigital.com

**TITLE: DOUBLE DOOR CABINET**

<b>JOB#:</b> 10-001	<b>DRAWN:</b> Hi-Tech	<b>REV:</b>
<b>DATE:</b> 12-29-2020	<b>SCALE:</b> 1/12	<b>PAGE:</b> 3 of 16

ID	Hole	Counter Hole	Qty	Side	Comment
A	Dia. 0 - 1/8 DEEP		4	AS SHOWN	
B	Dia. 3/8 - 3/8 DEEP		37	AS SHOWN	
ZC	Dia. 3/8 - 3/4 DEEP		2	EDGE	

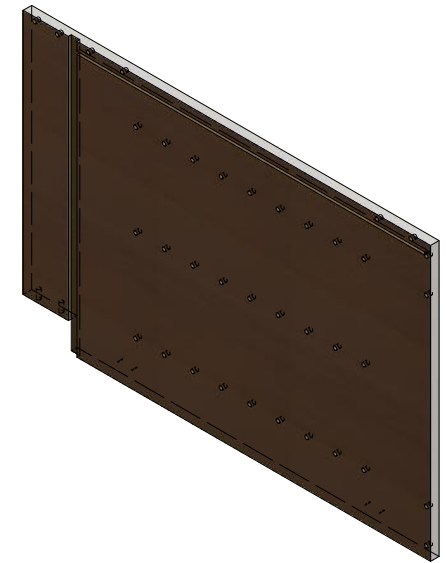
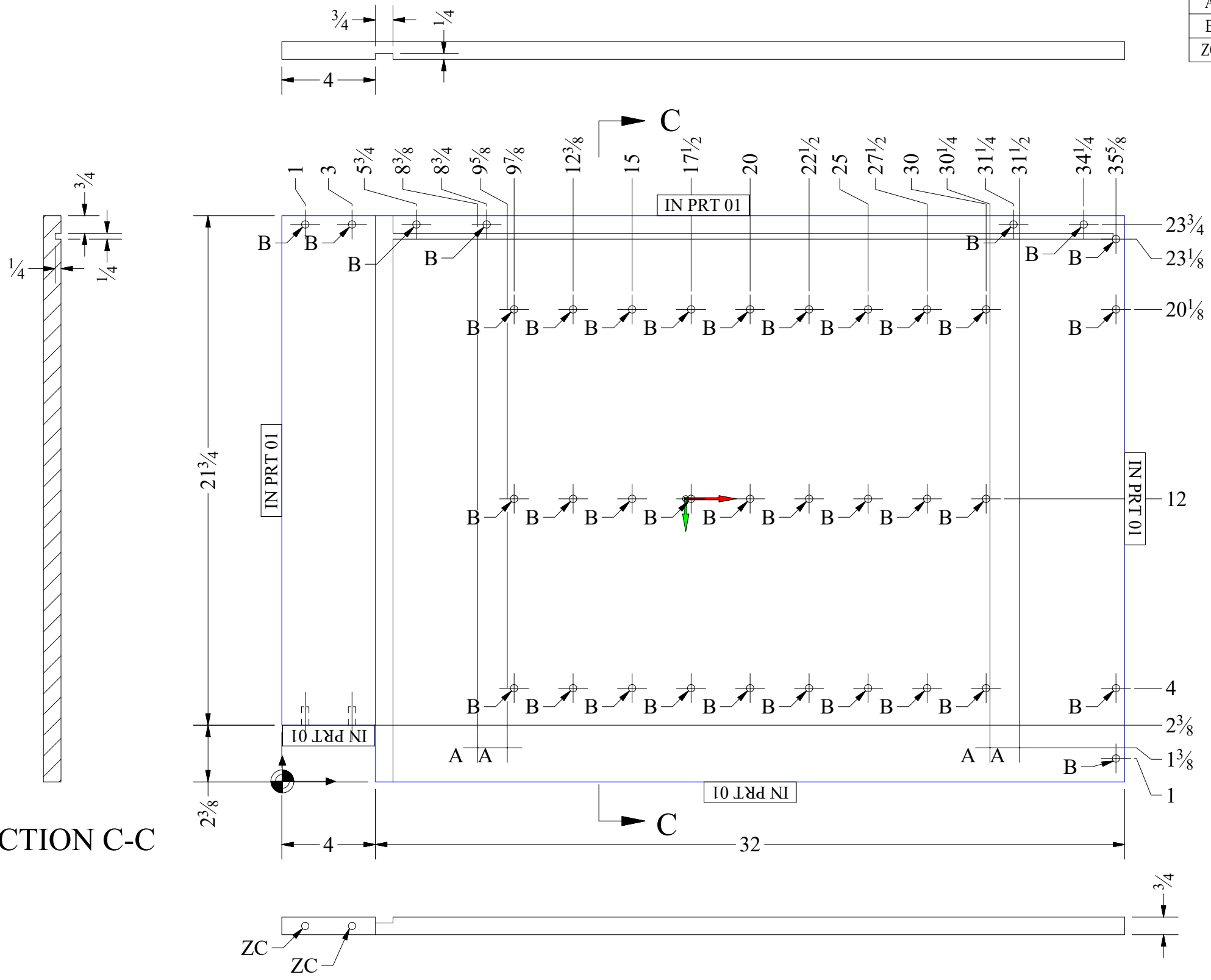

SECTION C-C

REV:	DESCRIPTION	BY:	DATE:

**hitech**  **Hi-Tech iSolutions LLP**  
 Commerce House-4,  
 9th Floor, Prahaladnagar, Ahmedabad  
 Phone:+91-794-000-3000  
 www.hitechdigital.com

**TITLE: DOUBLE DOOR CABINET**

001	RIGHT PANEL		
Part Size:	36x24 1/8x3/4		
Workpiece Size:	36x24 1/8x3/4		
<b>Material properties</b>			
Code:	LMDF	Name:	Laminated Medium Density Fiberboard
<b>Color properties</b>			
Code:	B01	Name:	Body 01 group color

JOB#:	DRAWN:	REV:
10-001	Hi-Tech	
DATE:	SCALE:	PAGE:
12-29-2020	1/5	4 of 16

ID	Hole	Counter Hole	Qty	Side	Comment
A	Dia. 0 - 1/8 DEEP		4	AS SHOWN	
B	Dia. 3/8 - 3/8 DEEP		37	AS SHOWN	
ZC	Dia. 3/8 - 3/4 DEEP		2	EDGE	

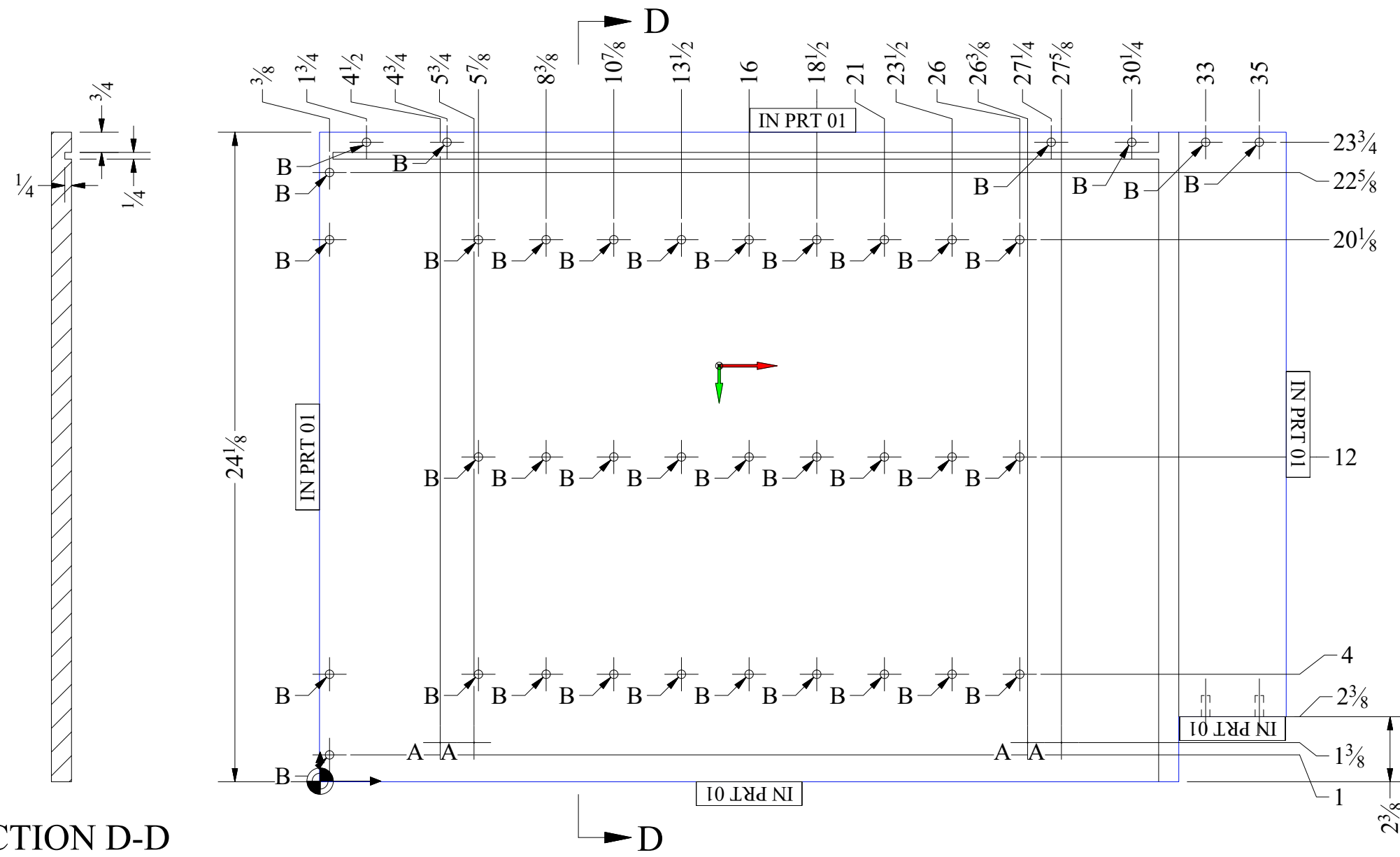

REV:	DESCRIPTION	BY:	DATE:

**Hi-Tech iSolutions LLP**  
 Commerce House-4,  
 9th Floor, Prahaladnagar, Ahmedabad  
 Phone:+91-794-000-3000  
 www.hitechdigital.com

<b>TITLE: DOUBLE DOOR CABINET</b>		
<b>JOB#:</b>	<b>DRAWN:</b>	<b>REV:</b>
<b>10-001</b>	<b>Hi-Tech</b>	
<b>DATE:</b>	<b>SCALE:</b>	<b>PAGE:</b>
12-29-2020	1/5	5 of 16

SECTION D-D

002	LEFT PANEL		
<b>Part Size:</b>	36x24 1/8x3/4		
<b>Workpiece Size:</b>	36x24 1/8x3/4		
<b>Material properties</b>			
<b>Code:</b>	LMDF	<b>Name:</b>	Laminated Medium Density Fiberboard
<b>Color properties</b>			
<b>Code:</b>	B01	<b>Name:</b>	Body 01 group color

ID	Hole	Counter Hole	Qty	Side	Comment
ZA	Dia. 3/8 - 3/4 DEEP		4	EDGE	

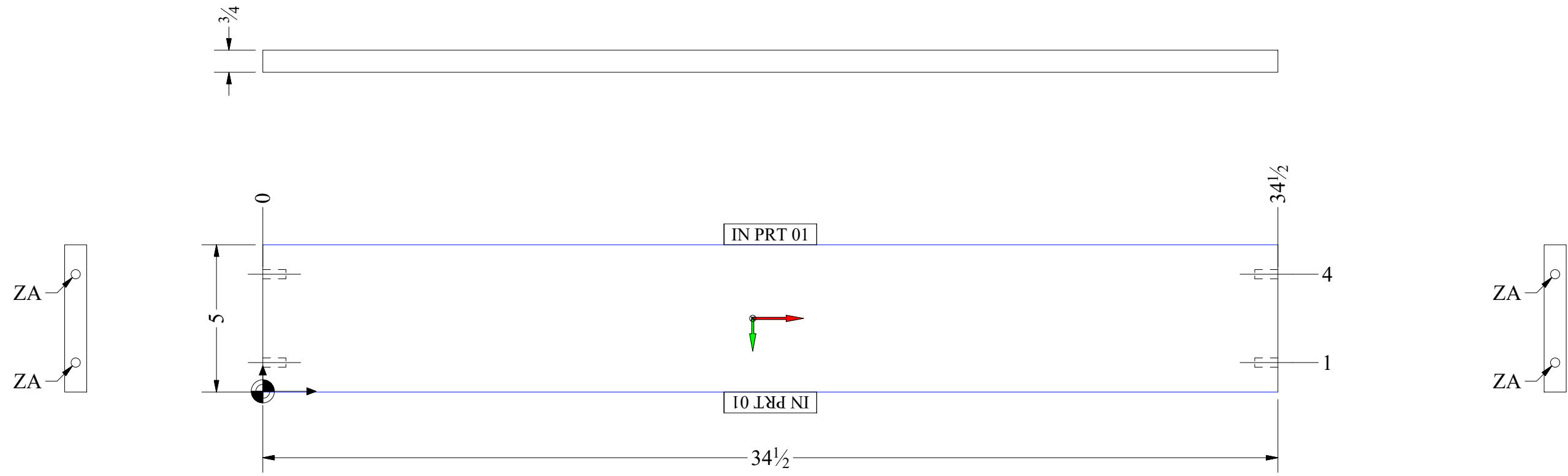

REV:	DESCRIPTION	BY:	DATE:

**Hi-Tech iSolutions LLP**  
 Commerce House-4,  
 9th Floor, Prahaladnagar, Ahmedabad  
 Phone:+91-794-000-3000  
 www.hitechdigital.com

**TITLE: DOUBLE DOOR CABINET**

JOB#:	DRAWN:	REV:
10-001	Hi-Tech	
DATE:	SCALE:	PAGE:
12-29-2020	1/4	6 of 16

003	TOP NAILBOARD 1		
Part Size:	34 1/2x5x3/4		
Workpiece Size:	34 1/2x5x3/4		
<b>Material properties</b>			
Code:	LCB	Name:	Laminated Cardboard
<b>Color properties</b>			
Code:	F01	Name:	Facade 01 group color

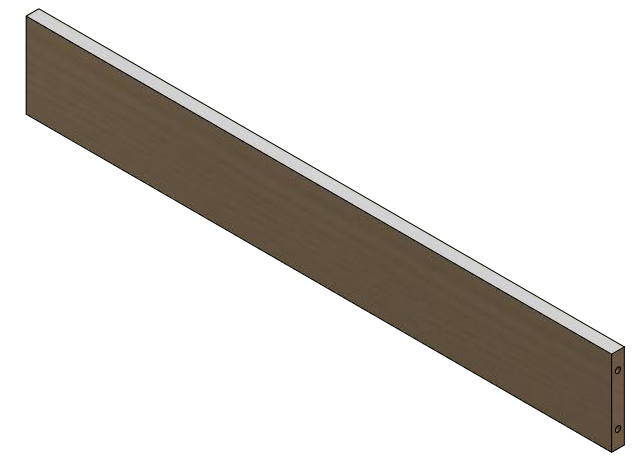

ID	Hole	Counter Hole	Qty	Side	Comment
A	Dia. 3/8 - 3/8 DEEP		3	AS SHOWN	
ZB	Dia. 3/8 - 3/4 DEEP		4	EDGE	

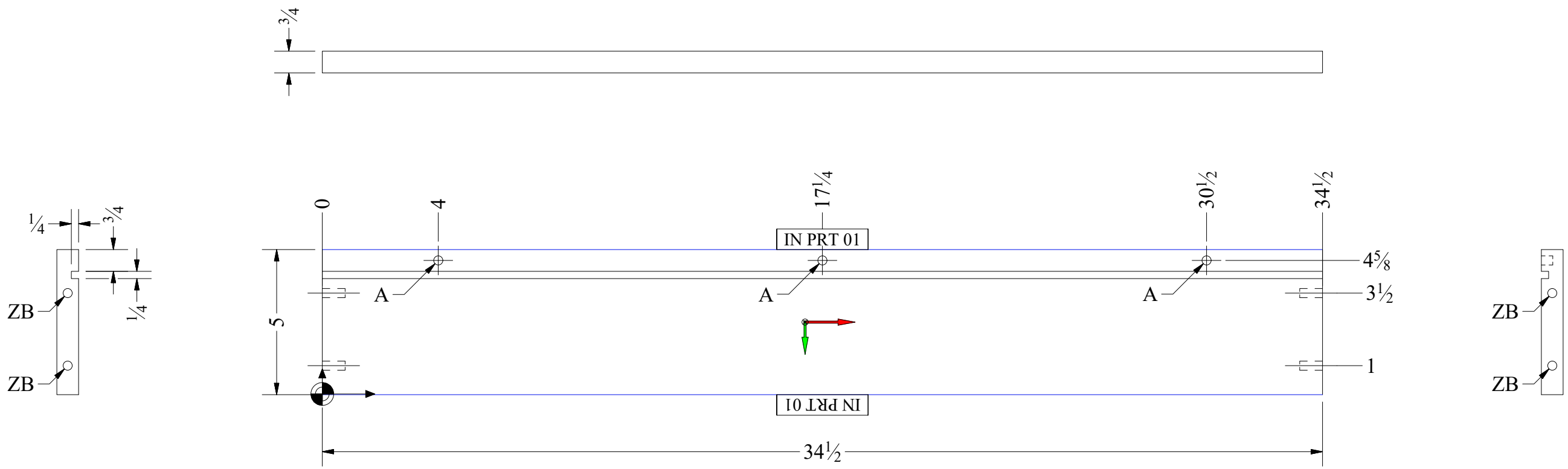

REV:	DESCRIPTION	BY:	DATE:



**Hi-Tech iSolutions LLP**  
 Commerce House-4,  
 9th Floor, Prahaladnagar, Ahmedabad  
 Phone:+91-794-000-3000  
 www.hitechdigital.com

**TITLE: DOUBLE DOOR CABINET**

JOB#:	DRAWN:	REV:
10-001	Hi-Tech	
DATE:	SCALE:	PAGE:
12-29-2020	1/4	7 of 16

004	TOP NAILBOARD 2		
Part Size:	34 1/2x5x3/4		
Workpiece Size:	34 1/2x5x3/4		
<b>Material properties</b>			
Code:	LCB	Name:	Laminated Cardboard
<b>Color properties</b>			
Code:	F01	Name:	Facade 01 group color

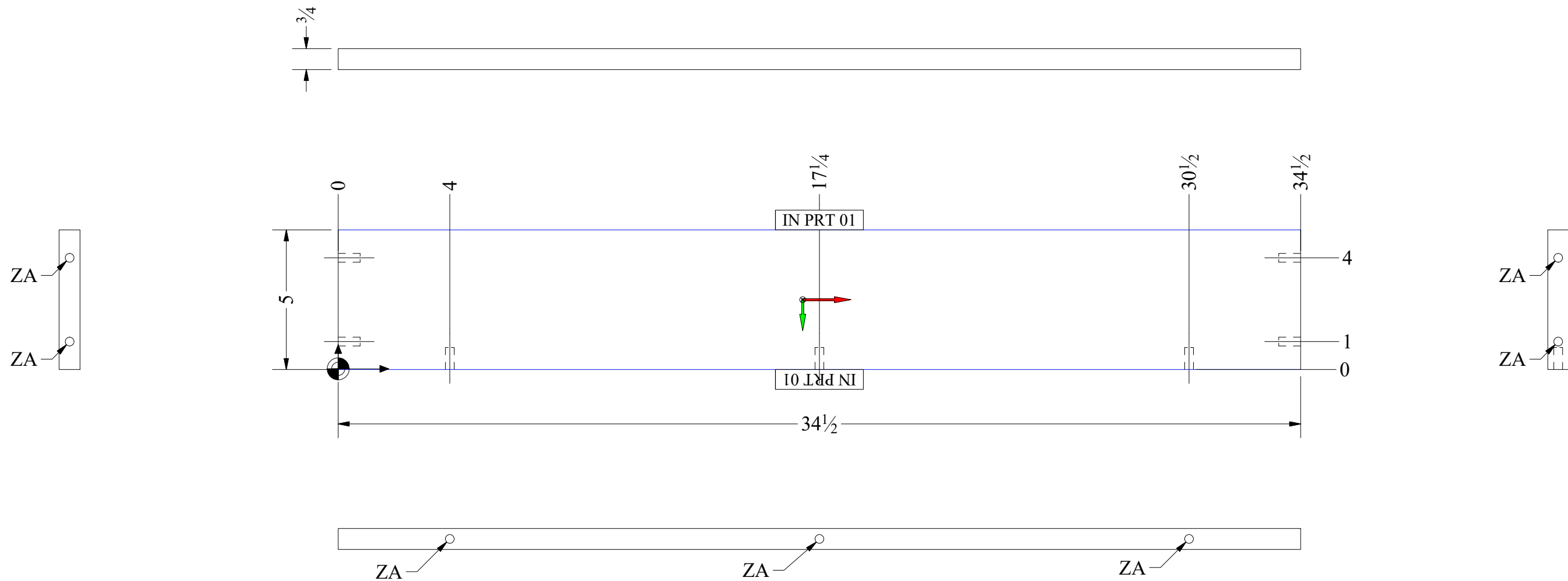
ID	Hole	Counter Hole	Qty	Side	Comment
ZA	Dia. 3/8 - 3/4 DEEP		7	EDGE	



REV:	DESCRIPTION	BY:	DATE:

**Hi-Tech iSolutions LLP**  
 Commerce House-4,  
 9th Floor, Prahaladnagar, Ahmedabad  
 Phone:+91-794-000-3000  
 www.hitechdigital.com

TITLE: DOUBLE DOOR CABINET		
<b>JOB#:</b>	<b>DRAWN:</b>	<b>REV:</b>
10-001	Hi-Tech	
<b>DATE:</b>	<b>SCALE:</b>	<b>PAGE:</b>
12-29-2020	1/4	8 of 16

005	BACK NAILBOARD 1		
<b>Part Size:</b>	34 1/2x5x3/4		
<b>Workpiece Size:</b>	34 1/2x5x3/4		
<b>Material properties</b>			
<b>Code:</b>	LCB	<b>Name:</b>	Laminated Cardboard
<b>Color properties</b>			
<b>Code:</b>	F01	<b>Name:</b>	Facade 01 group color

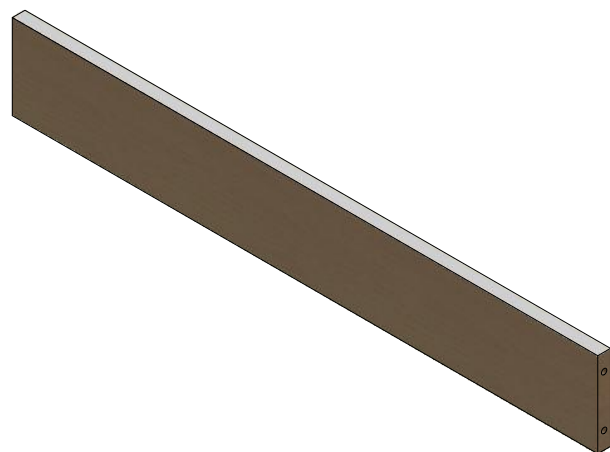



ID	Hole	Counter Hole	Qty	Side	Comment
ZA	Dia. 3/8 - 3/4 DEEP		7	EDGE	

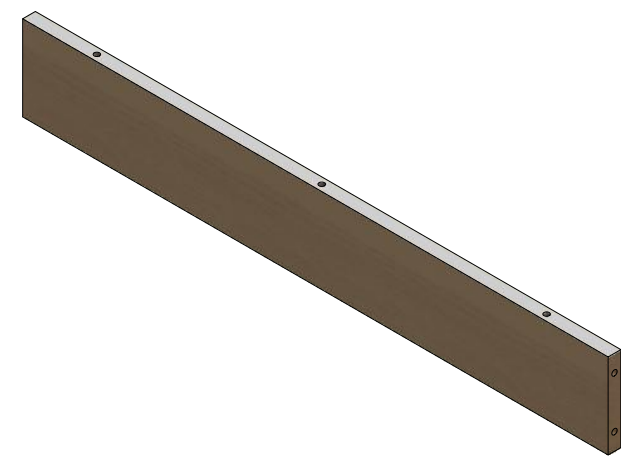
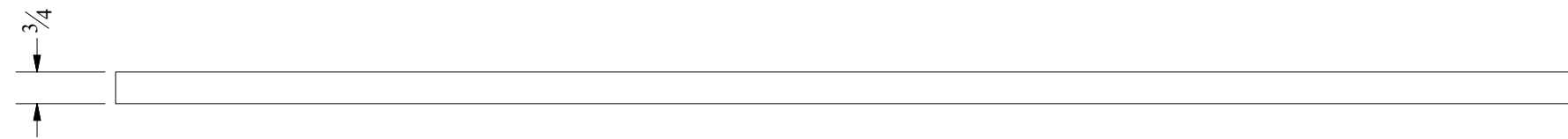
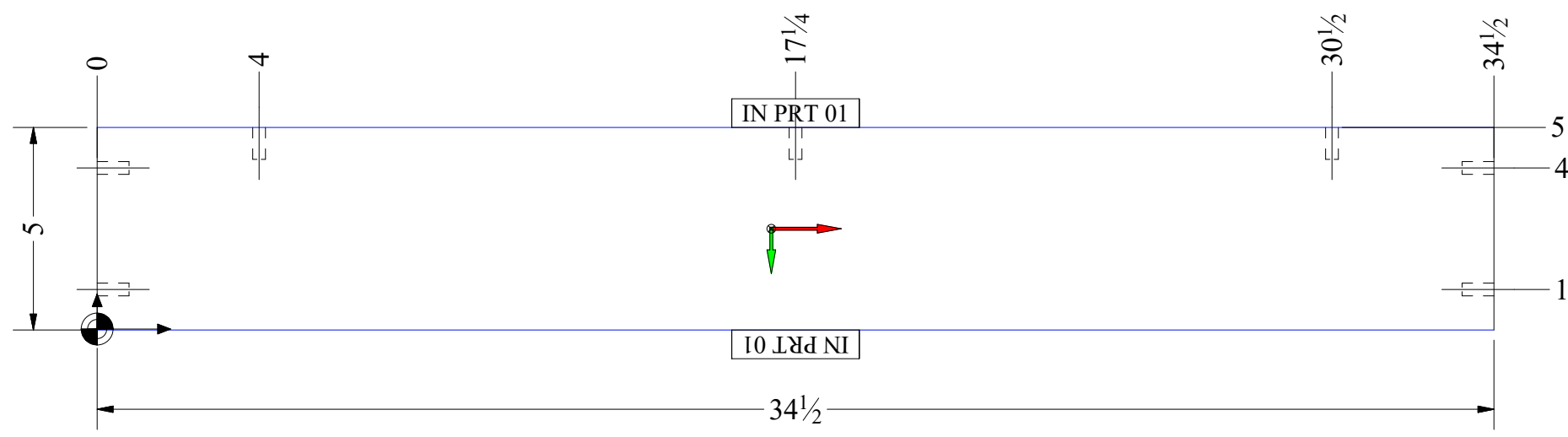
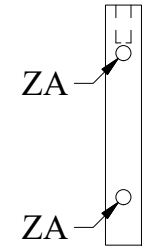
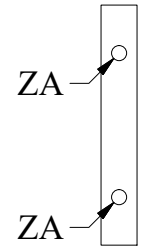
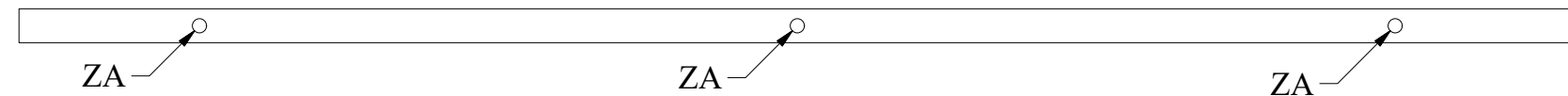

REV:	DESCRIPTION	BY:	DATE:

**Hi-Tech iSolutions LLP**  
 Commerce House-4,  
 9th Floor, Prahaladnagar, Ahmedabad  
 Phone:+91-794-000-3000  
 www.hitechdigital.com

006		BACK NAILBOARD 2	
Part Size:	34 1/2x5x3/4		
Workpiece Size:	34 1/2x5x3/4		
<b>Material properties</b>			
Code:	LCB	Name:	Laminated Cardboard
<b>Color properties</b>			
Code:	F01	Name:	Facade 01 group color

<b>TITLE: DOUBLE DOOR CABINET</b>		
<b>JOB#:</b>	<b>DRAWN:</b>	<b>REV:</b>
10-001	Hi-Tech	
<b>DATE:</b>	<b>SCALE:</b>	<b>PAGE:</b>
12-29-2020	1/4	9 of 16

ID	Hole	Counter Hole	Qty	Side	Comment
A	Dia. 3/8 - 3/8 DEEP		3	AS SHOWN	

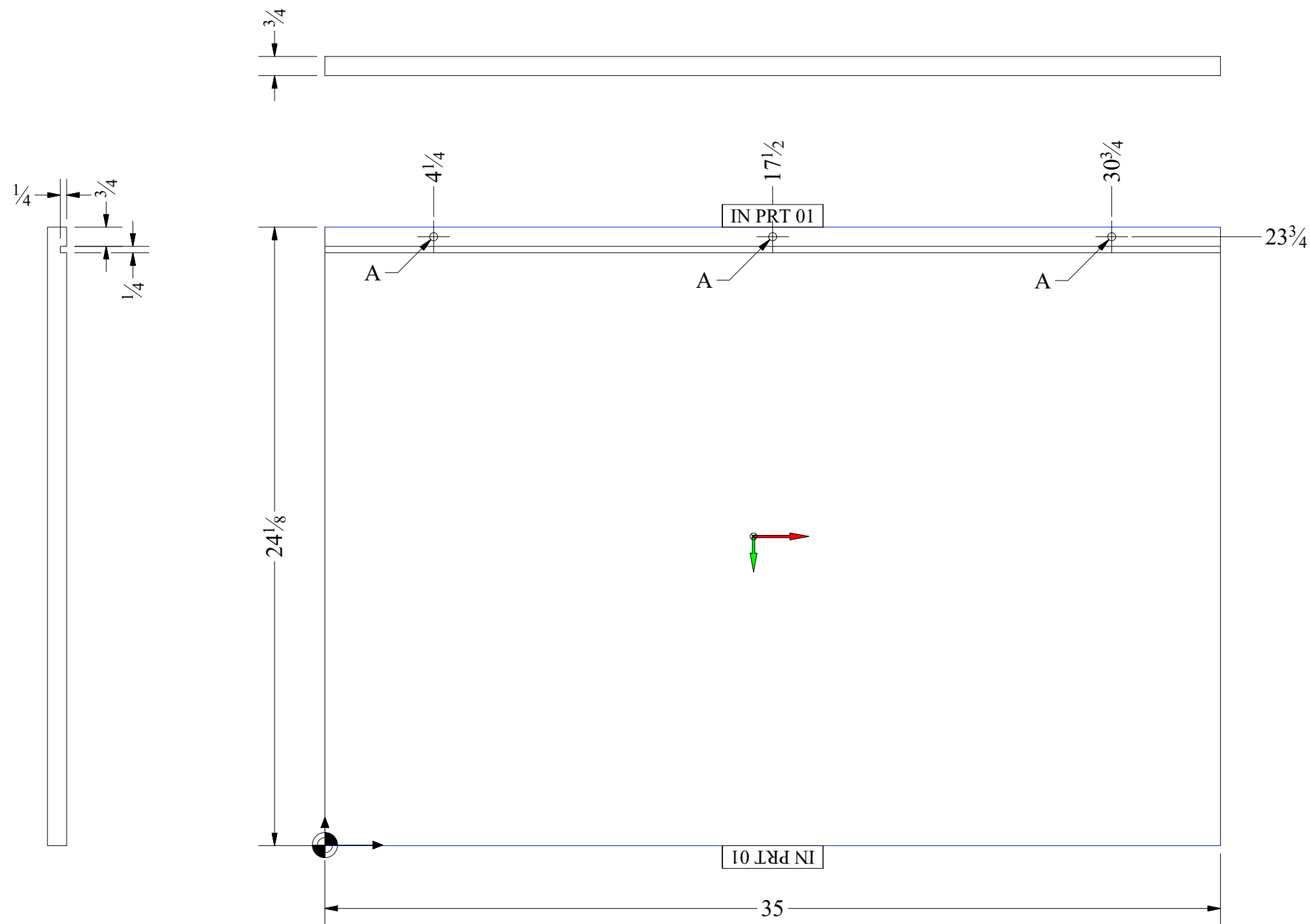

REV:	DESCRIPTION	BY:	DATE:

**Hi-Tech iSolutions LLP**  
 Commerce House-4,  
 9th Floor, Prahaladnagar, Ahmedabad  
 Phone:+91-794-000-3000  
 www.hitechdigital.com

TITLE: DOUBLE DOOR CABINET		
<b>JOB#:</b>	<b>DRAWN:</b>	<b>REV:</b>
10-001	Hi-Tech	
<b>DATE:</b>	<b>SCALE:</b>	<b>PAGE:</b>
12-29-2020	1/5	10 of 16

007		BOTTOM PANEL	
<b>Part Size:</b>	35x24 1/8x3/4		
<b>Workpiece Size:</b>	35x24 1/8x3/4		
<b>Material properties</b>			
<b>Code:</b>	LMDF	<b>Name:</b>	Laminated Medium Density Fiberboard
<b>Color properties</b>			
<b>Code:</b>	B01	<b>Name:</b>	Body 01 group color

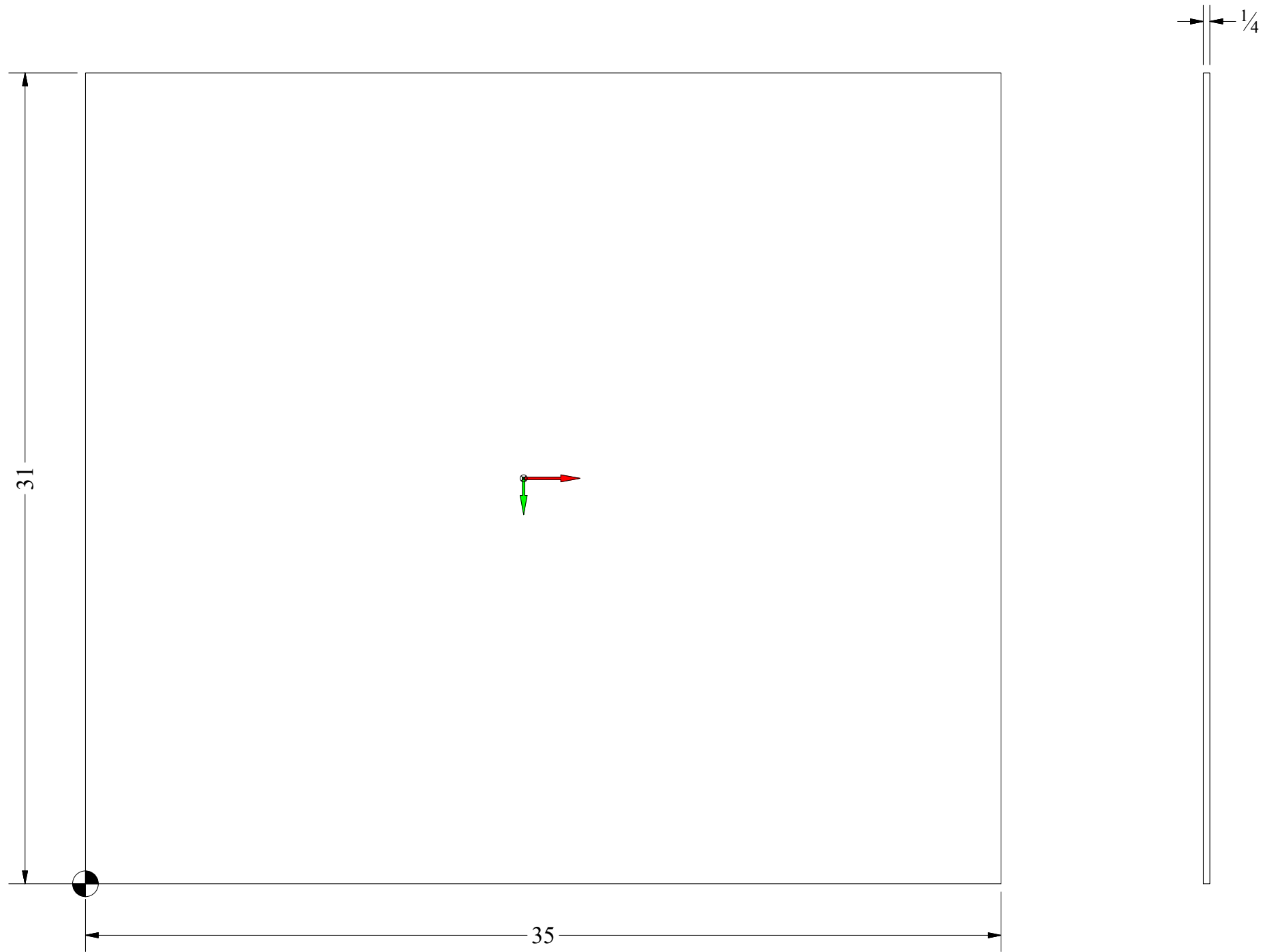

REV:	DESCRIPTION	BY:	DATE:



**Hi-Tech iSolutions LLP**  
 Commerce House-4,  
 9th Floor, Prahaladnagar, Ahmedabad  
 Phone:+91-794-000-3000  
 www.hitechdigital.com

**TITLE: DOUBLE DOOR CABINET**

<b>JOB#:</b>	<b>DRAWN:</b>	<b>REV:</b>
10-001	Hi-Tech	
<b>DATE:</b>	<b>SCALE:</b>	<b>PAGE:</b>
12-29-2020	1/5	11 of 16

008	BACK PANEL		
<b>Part Size:</b>	35x31x1/4		
<b>Workpiece Size:</b>	35x31x1/4		
<b>Material properties</b>			
<b>Code:</b>	LMDF	<b>Name:</b>	Laminated Medium Density Fiberboard
<b>Color properties</b>			
<b>Code:</b>	B01	<b>Name:</b>	Body 01 group color

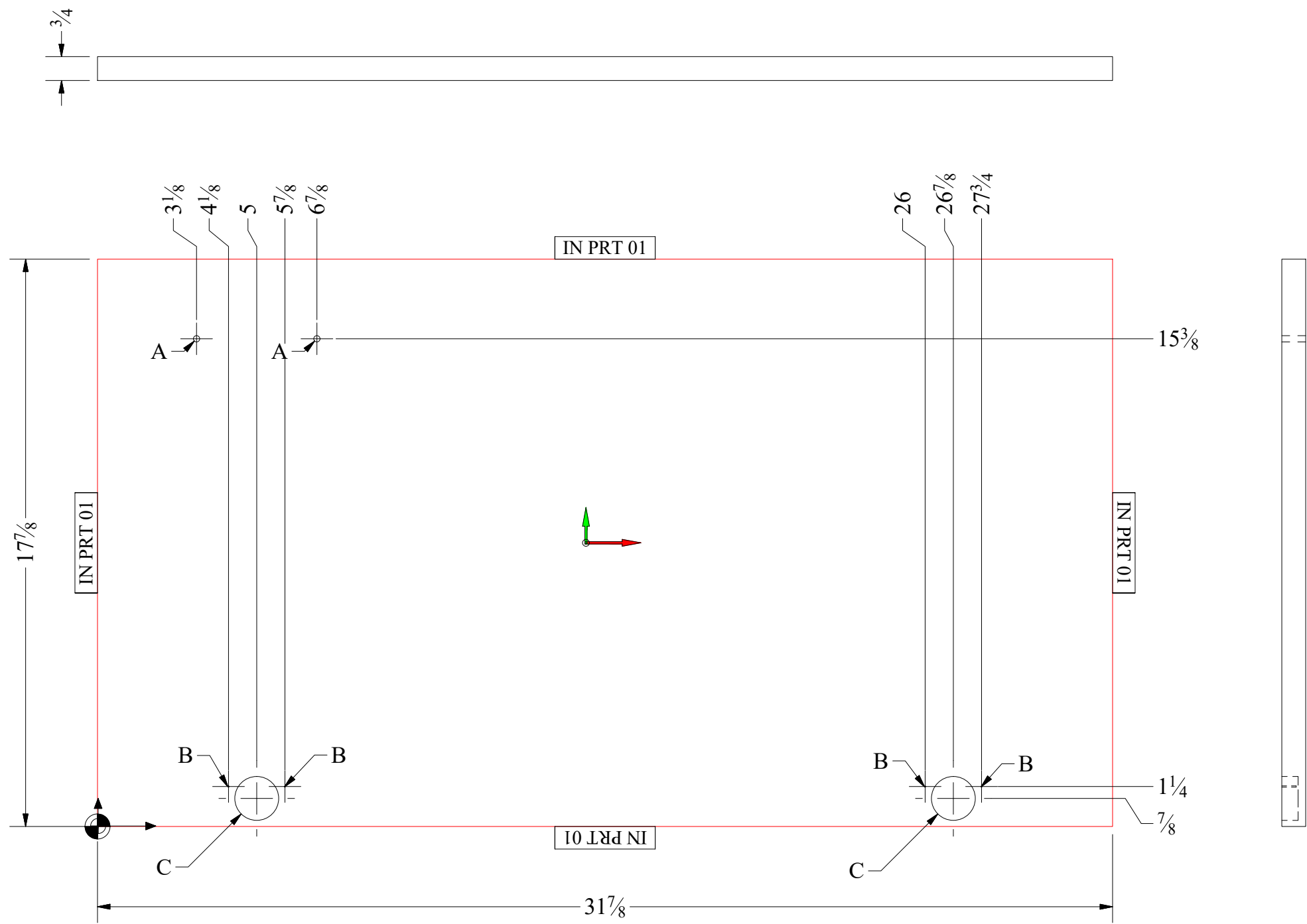
ID	Hole	Counter Hole	Qty	Side	Comment
A	Dia. 1/4 THRU		2	AS SHOWN	
B	Dia. 0 - 1/8 DEEP		4	AS SHOWN	
C	Dia. 1 3/8 - 1/2 DEEP		2	AS SHOWN	



REV:	DESCRIPTION	BY:	DATE:

**Hi-Tech iSolutions LLP**  
 Commerce House-4,  
 9th Floor, Prahaladnagar, Ahmedabad  
 Phone:+91-794-000-3000  
 www.hitechdigital.com

**TITLE: DOUBLE DOOR CABINET**

JOB#:	DRAWN:	REV:
10-001	Hi-Tech	
DATE:	SCALE:	PAGE:
12-29-2020	1/4	12 of 16

009	RIGHT DOOR		
Part Size:	31 7/8x17 7/8x3/4		
Workpiece Size:	31 3/4x17 5/8x3/4		
<b>Material properties</b>			
Code:	LMDF	Name:	Laminated Medium Density Fiberboard
<b>Color properties</b>			
Code:	B02	Name:	Body 02 group color

ID	Hole	Counter Hole	Qty	Side	Comment
A	Dia. 1/4 THRU		2	AS SHOWN	
B	Dia. 0 - 1/8 DEEP		4	AS SHOWN	
C	Dia. 1 3/8 - 1/2 DEEP		2	AS SHOWN	

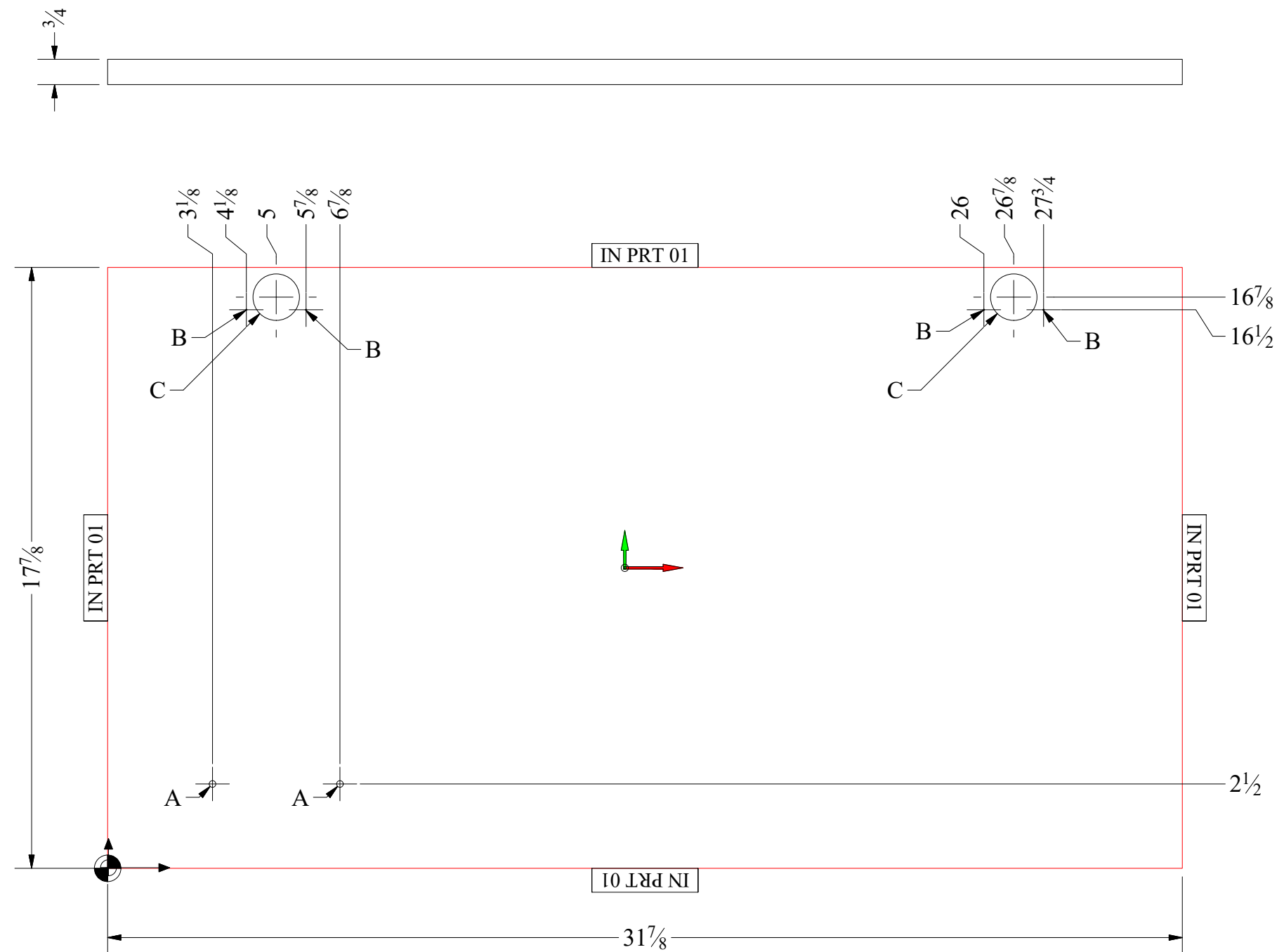

REV:	DESCRIPTION	BY:	DATE:

**Hi-Tech iSolutions LLP**  
 Commerce House-4,  
 9th Floor, Prahaladnagar, Ahmedabad  
 Phone:+91-794-000-3000  
 www.hitechdigital.com

TITLE: DOUBLE DOOR CABINET		
JOB#:	DRAWN:	REV:
10-001	Hi-Tech	
DATE:	SCALE:	PAGE:
12-29-2020	1/4	13 of 16

010		LEFT DOOR	
Part Size:	31 7/8x17 3/4x3/4		
Workpiece Size:	31 3/4x17 5/8x3/4		
<b>Material properties</b>			
Code:	LMDF	Name:	Laminated Medium Density Fiberboard
<b>Color properties</b>			
Code:	B02	Name:	Body 02 group color

ID	Hole	Counter Hole	Qty	Side	Comment
ZA	Dia. 3/8 - 5/8 DEEP		6	EDGE	

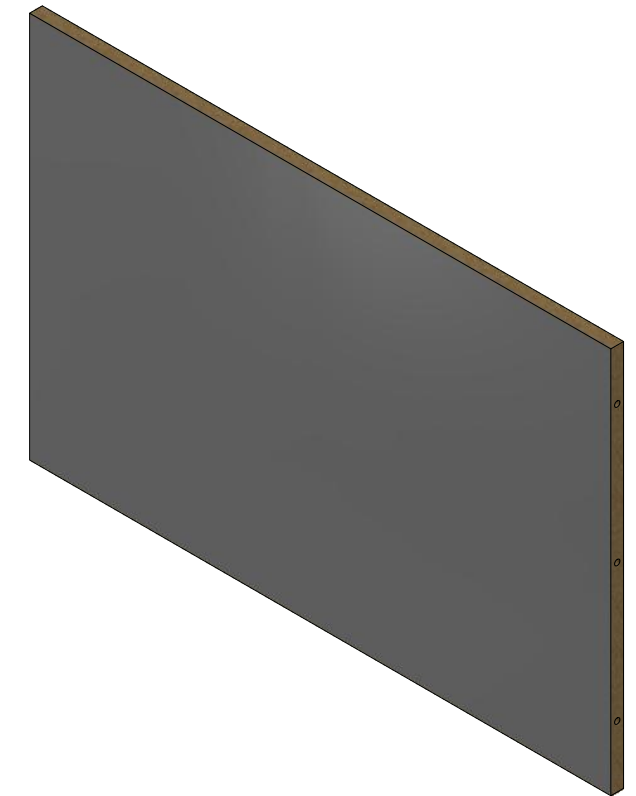
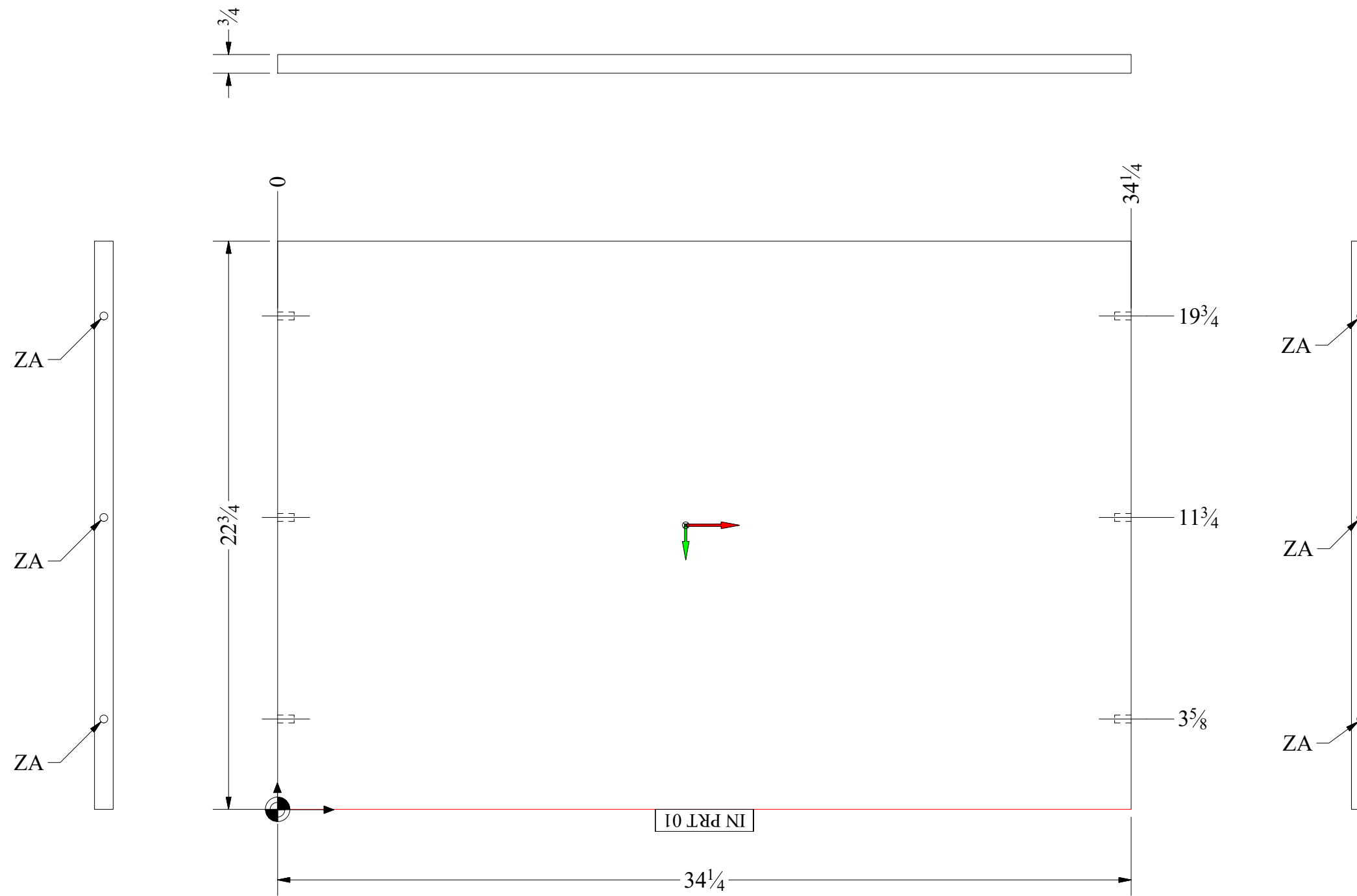

REV:	DESCRIPTION	BY:	DATE:



**Hi-Tech iSolutions LLP**  
 Commerce House-4,  
 9th Floor, Prahaladnagar, Ahmedabad  
 Phone:+91-794-000-3000  
 www.hitechdigital.com

**TITLE: DOUBLE DOOR CABINET**

JOB#:	DRAWN:	REV:
10-001	Hi-Tech	
DATE:	SCALE:	PAGE:
12-29-2020	1/5	14 of 16

011		ADJUSTABLE SHELF	
Part Size:	34 1/4x22 3/4x3/4		
Workpiece Size:	34 1/4x22 3/4x3/4		
Material properties			
Code:	LMDF	Name:	Laminated Medium Density Fiberboard
Color properties			
Code:	IN PRT 01	Name:	Inner Parts 01 group color

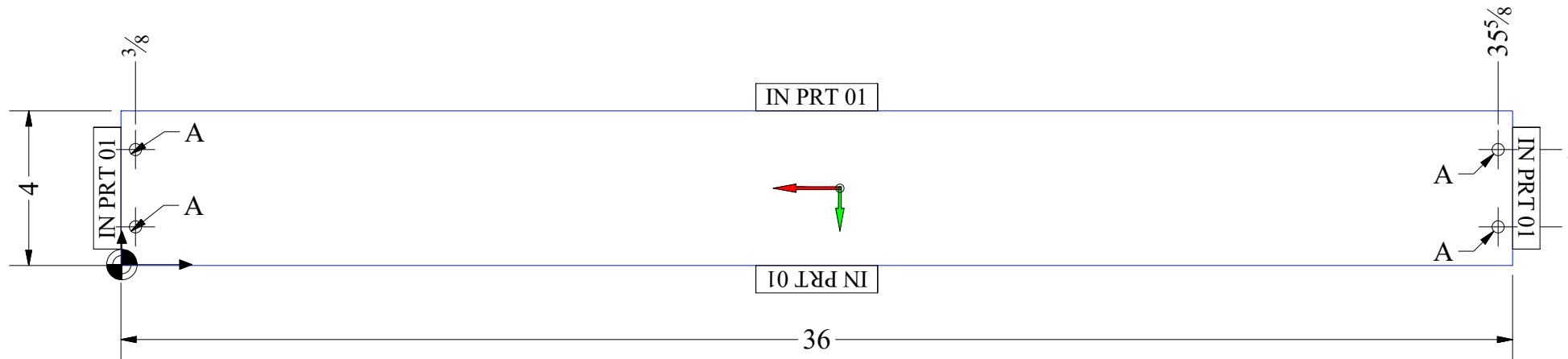
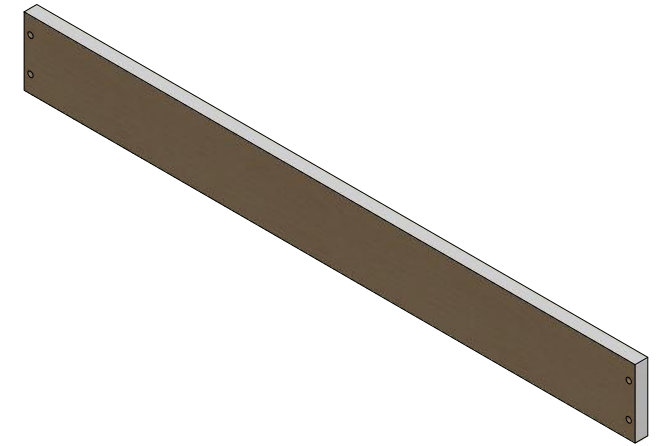
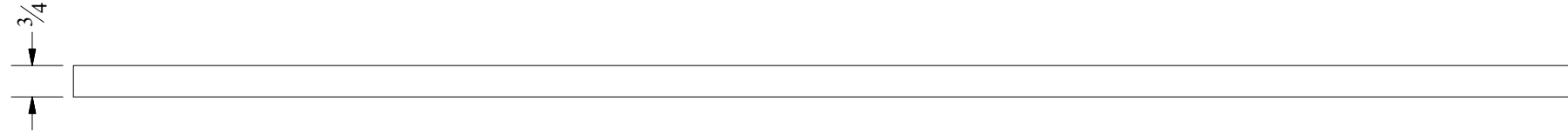
ID	Hole	Counter Hole	Qty	Side	Comment
A	Ø3/8 - 3/8 DEEP		4	AS SHOWN	



REV:	DESCRIPTION	BY:	DATE:



**Hi-Tech iSolutions LLP**  
 Commerce House-4,  
 9th Floor, Prahaladnagar, Ahmedabad  
 Phone:+91-794-000-3000  
 www.hitechdigital.com

**TITLE: DOUBLE DOOR CABINET**

JOB#:	DRAWN:	REV:
10-001	Hi-Tech	
DATE:	SCALE:	PAGE:
12-29-2020	1/4	15 of 16

012	FRONT TOE KICK		
Part Size:	36x4x3/4		
Workpiece Size:	36x4x3/4		
<b>Material properties</b>			
Code:	LCB	Name:	Laminated Cardboard
<b>Color properties</b>			
Code:	F01	Name:	Facade 01 group color

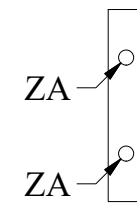
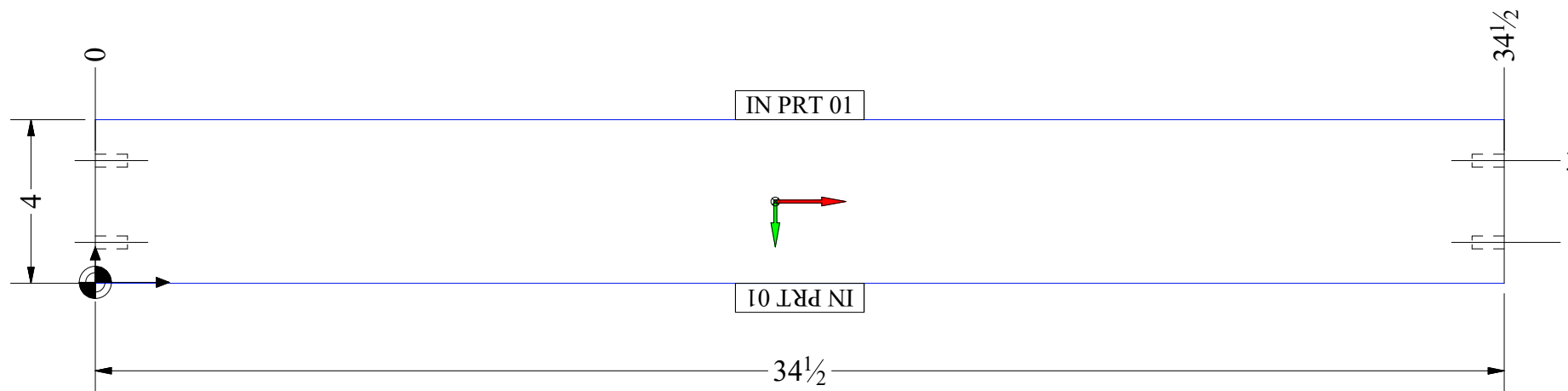
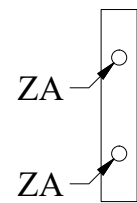
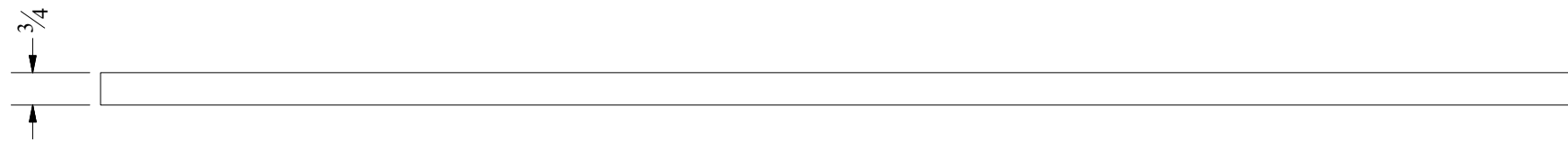
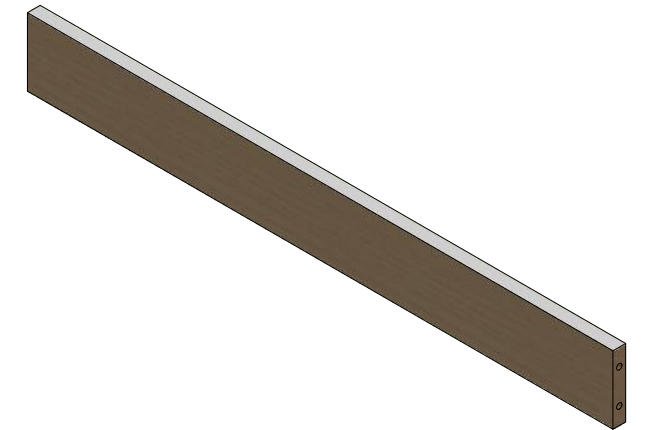
ID	Hole	Counter Hole	Qty	Side	Comment
ZA	Ø3/8 - 3/4 DEEP		4	EDGE	



REV:	DESCRIPTION	BY:	DATE:

**Hi-Tech iSolutions LLP**  
 Commerce House-4,  
 9th Floor, Prahaladnagar, Ahmedabad  
 Phone:+91-794-000-3000  
 www.hitechdigital.com

013	REAR TOE KICK		
Part Size:	34 1/2x4x3/4		
Workpiece Size:	34 1/2x4x3/4		
<b>Material properties</b>			
Code:	LCB	Name:	Laminated Cardboard
<b>Color properties</b>			
Code:	F01	Name:	Facade 01 group color

<b>TITLE: DOUBLE DOOR CABINET</b>		
<b>JOB#:</b>	<b>DRAWN:</b>	<b>REV:</b>
10-001	Hi-Tech	
<b>DATE:</b>	<b>SCALE:</b>	<b>PAGE:</b>
12-29-2020	1/4	16 of 16